



Industrial signal light specially designed for tower and harbour cranes. Sturdy and reliable, it features a high degree of customization.

FEATURES

- Sturdy industrial signal light suitable for tower and harbour cranes.
- It features two to four Universal Signal Beacons and a Wall-Mounted Siren.
- Specially designed to guarantee excellent long-distance visibility.
- Featuring polycarbonate lenses and an ABS housing mounted on an aluminium plate.
- IP protection degree: the industrial signal light is classified IP65.
- Extreme temperature resistance: -20°C to +50°C.
- All materials and components used are wear resistant and guarantee protection of the unit against water and dust.

OPTIONS

- Possibility to switch the light modes by pressing a specific button on the switch board.
- Featuring customizable plate and configuration.
- Available with continuous or intermittent sound siren, or without.

CERTIFICATIONS

- CE marking.



CERTIFICATIONS

| | |
|------------------------------------|---|
| Conformity to Community Directives | 2014/35/UE Low Voltage Directive |
| Conformity to CE Standards | EN 60598-1 Luminaires - General requirements and tests |
| | EN 60529-1 Degrees of protection provided by enclosures |
| Markings and homologations | CE |

GENERAL TECHNICAL SPECIFICATIONS

| | |
|-----------------------|---|
| Ambient temperature | Operational -20°C/+50°C |
| IP protection degree | IP 65 |
| | Lens: Polycarbonate |
| Materials | Housing: ABS |
| | Plate: aluminium |
| Lens diameter | 90 mm |
| LED module type | 5 x 3 W Power LED |
| LED life duration | 50.000 hrs |
| Power supply | 12 - 24 V AC/DC |
| | 40 - 230 V AC/DC |
| Current max | 660 mA |
| Light colours | White, red, yellow, green |
| Light modes | Steady, flashing, strobing, rotary |
| Sound | 2 sounds |
| Volume | 121 dB (10 cm) - 100 dB (100 cm) |
| Light changing button | Yes |
| Connections | M12 male connector - 5 PIN |
| | M12 male connector - 8 PIN (signal light with 4 lights + siren) |

OVERALL DIMENSIONS (mm)

Signal light with 2 lights + siren

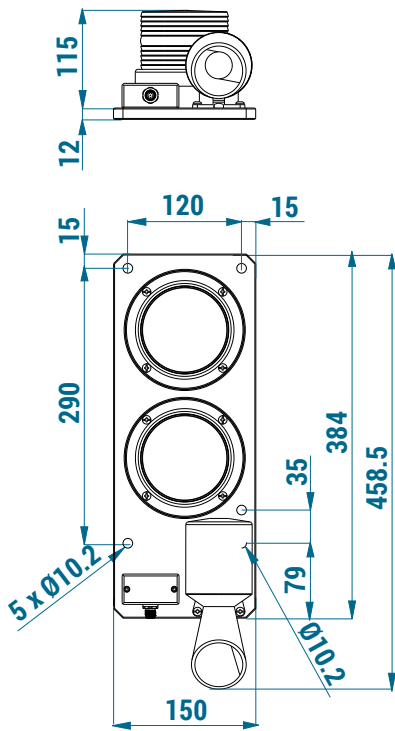

Signal light with 4 lights + siren

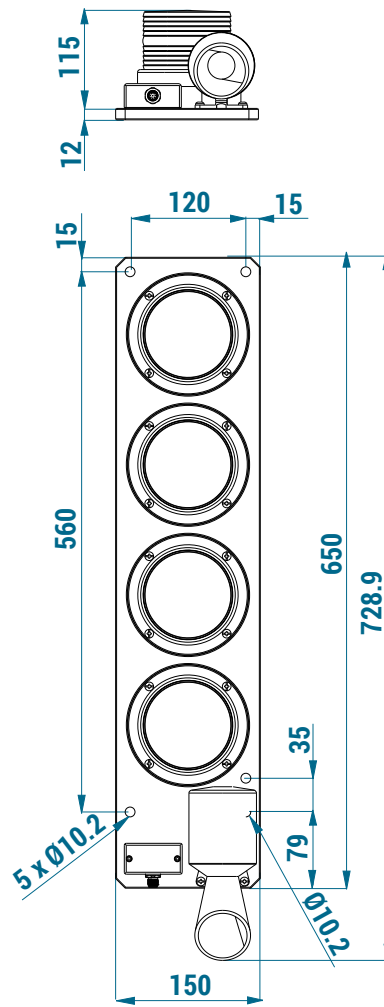

CONNECTOR ASSIGNMENT (front view)

5 PIN connector

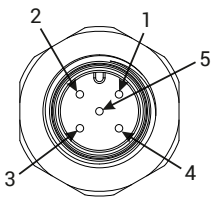

| PIN | Description |
|-----|-------------------------|
| 1 | Siren / White light |
| 2 | Red light |
| 3 | 0 V |
| 4 | Yellow light / Not used |
| 5 | Green light |

8 PIN connector (signal light with 4 lights + siren)

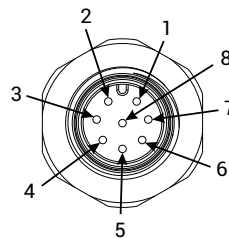

| PIN | Description |
|-----|--------------|
| 1 | Siren |
| 2 | Green light |
| 3 | White light |
| 4 | Red light |
| 5 | Yellow light |
| 6 | Not used |
| 7 | Not used |
| 8 | 0 V |

INDUSTRIAL SIGNAL LIGHT - REQUEST FORM

Instructions

- 1 Type:** select the required type.
- 2 Siren:** if the model with siren is required, indicate the type of sound desired.
- 3 Power supply:** select the type of power supply required.

Without siren **1**

- W White
- R Red
- Y Yellow
- G Green

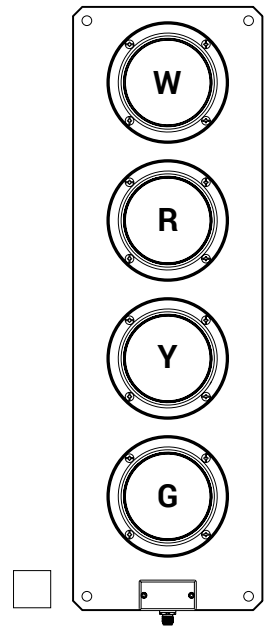
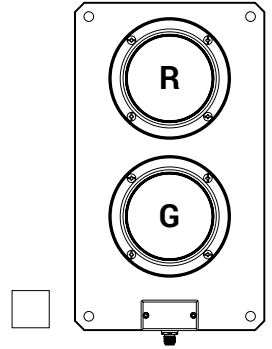

With siren

- W White
- R Red
- Y Yellow
- G Green

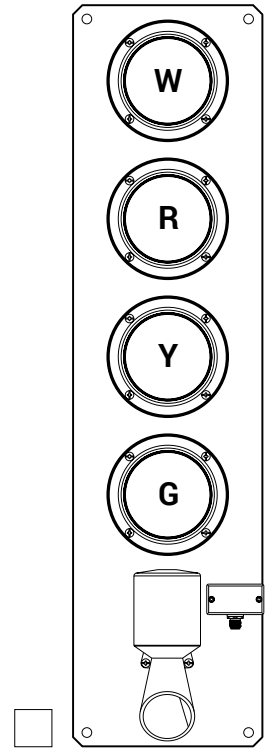
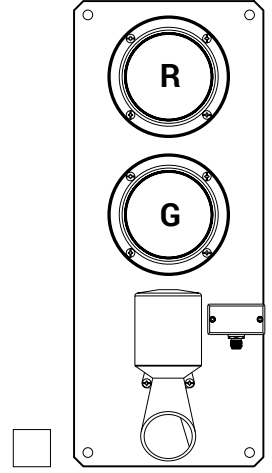

Siren **2**

- Siren with continuous sound
- Siren with intermittent sound

Power supply **3**

- 12 - 24 V AC/DC
- 40 - 230 V AC/DC

31032025

